

**100V-240V AC**

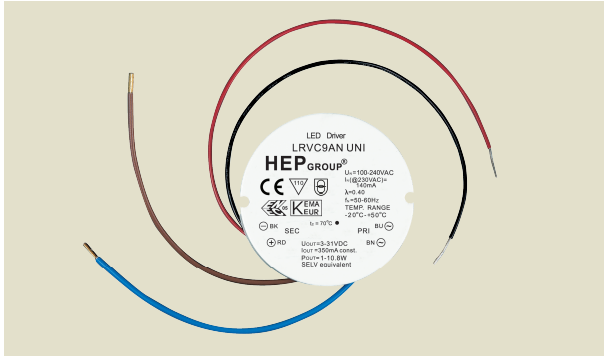

**Approval Marks**



**Certified**

EN 61347-1:2008  
EN 61347-2-13:2006  
EN 62384:2006

**Electronic**

Parameter	Conditions	Min	Nom	Max	Unit
I/P Voltage Range		90	230	264	Vac
Input Frequency		47	50-60	63	Hz
Output Power(Pout)	350mA LED	1	-	10.8	W
Input Current(Iin)	25°C,Nominal Input@230VAC	-	140	-	mA
Output Voltage(Vout)		3	-	31	Vdc
Output Current(Iout)	25°C,Nominal Input	315	350	385	mA
Power Factor	POWER FACTOR(Typical.)	-	0.40	-	
Protection	Overload Protection				
	Short Circuit Protection				
	Over Heat Protection				
Ambient Temp.		-20	-	+50	°C
Case Temp. (Tc)	Normal Conditions	-	-	+70	°C

**Lamp Type** High Power LED 1.2W x 1~9

**Application Space**

Indoor Use  
(Low Humidity, No Condensation)

**Physical**

**Parameter**

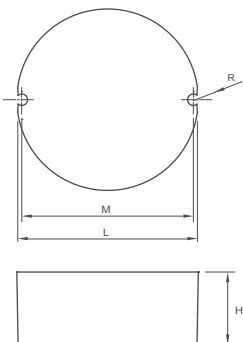

L : 55 mm H : 22 mm  
M : 52 mm K : mm  
N : mm R : 1.7 mm  
W : mm  
Tolerance :  $\geq 0 \sim 100 \geq \pm 0.5\text{mm}$   
 $100 \geq \pm 1 \text{ mm}$

Terminal Block : Hard Wires : PRI : Blue / Brown 149mm AWG#18  
SEC : Red / Black 190mm AWG#22

Housing Material : Polycarbonate  
Soldering : Lead-Free, Comply With RoHS  
Label : Surface Print

**Wiring Diagram**

